

Setting up your Google Account on your tablet

1. On your home screen, tap on the Google Suite folder on the top left, and open Google Drive as shown in the photo to the right below:

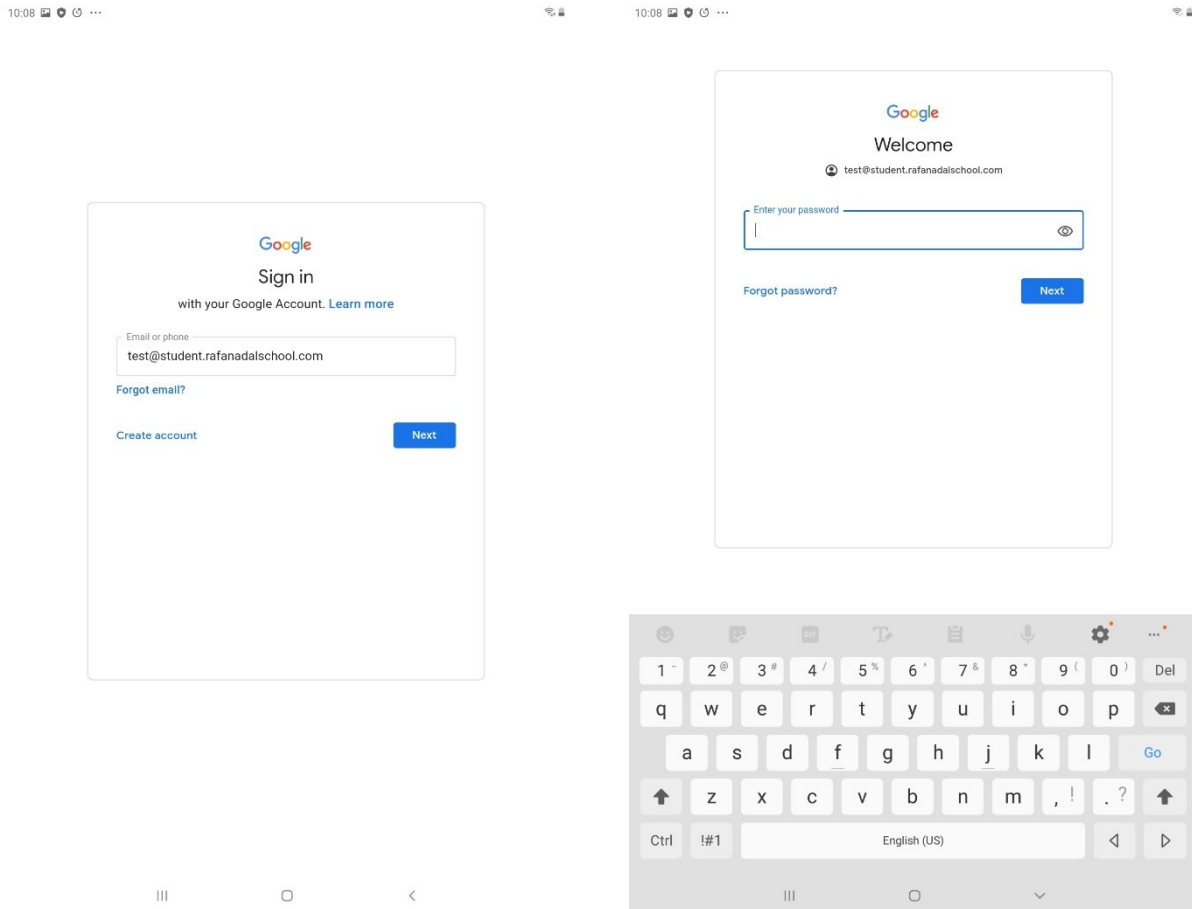

2. Once in Google Drive, sign in with your Google email. Use the password you already set on your first login.



3. Accept the terms and conditions:

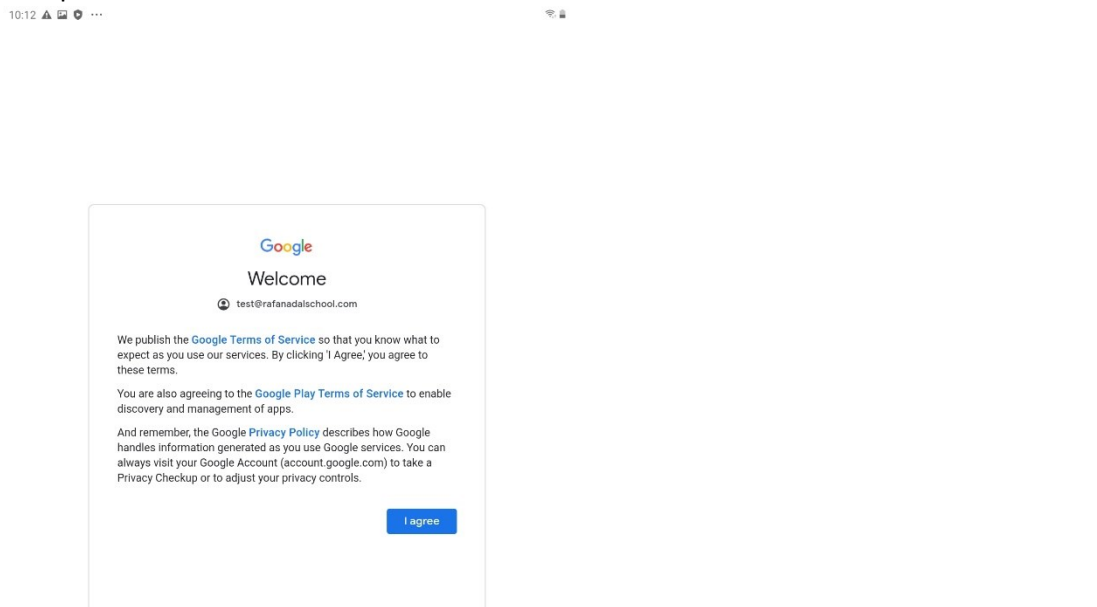

4. Now you will see the following screen, and to activate your account, you have to tap your profile icon on the top right, and later tap on “Manage your Google Account”:

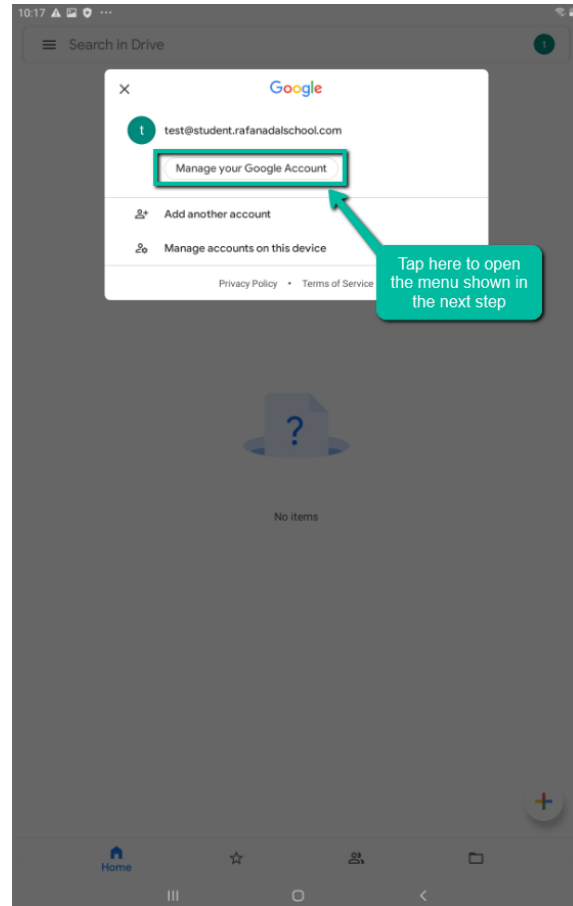

5. Tap on "Sign in" as shown below, and later tap on "Next" to setup your tablet password:

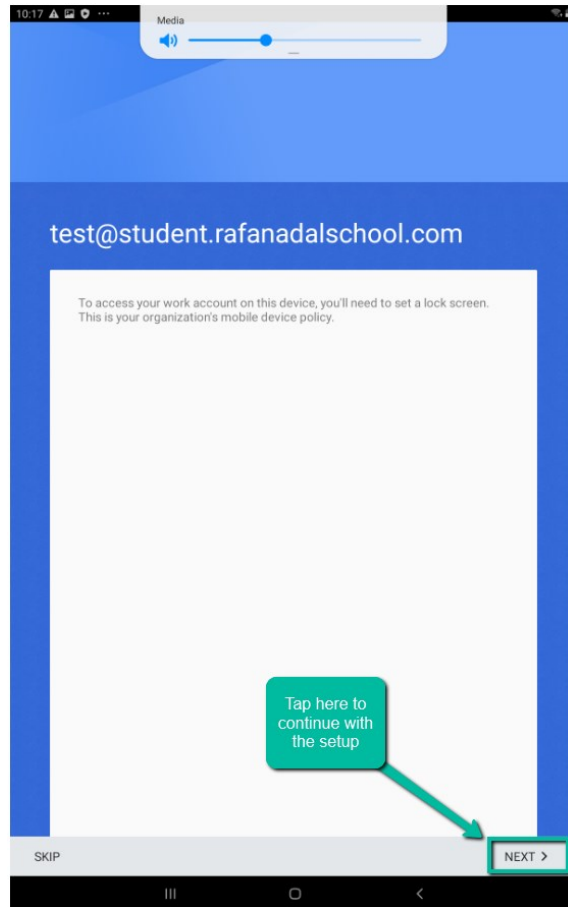
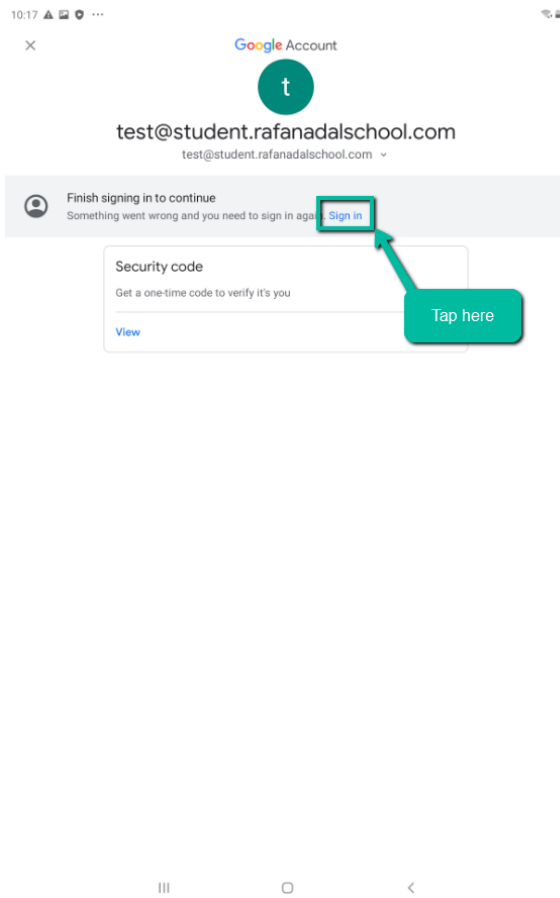

6. **IMPORTANT:** use the **PIN lock type**. This passcode is only used when the tablet is turned off completely or restarted. **Set the code to "2020"**.
Not setting the lock type to PIN, and/or setting the code to something different to "2020", will make you responsible of remembering the code in case of any issue, which may leave you without your tablet until resolved.

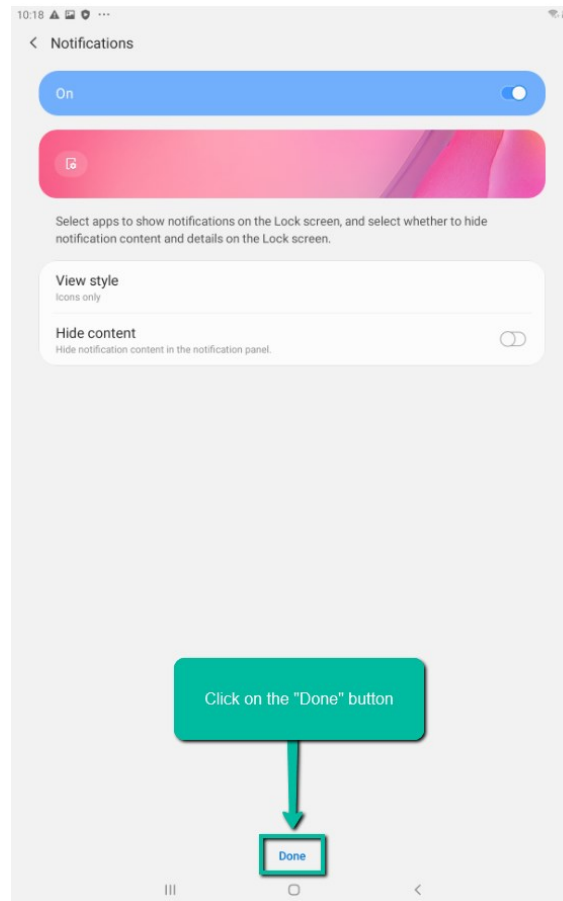
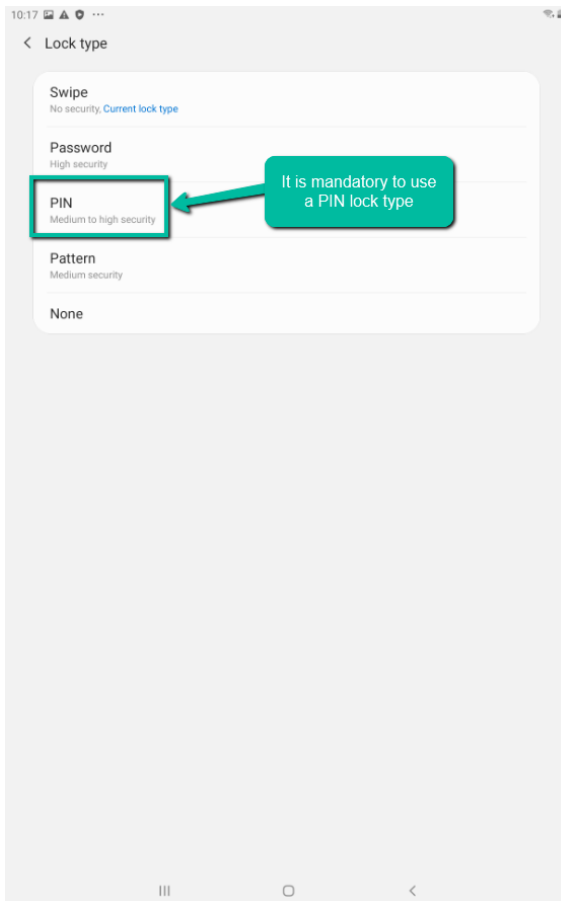

7. At this point the same message in step 5 may appear, just click on “Sign in”, and you should be all setup

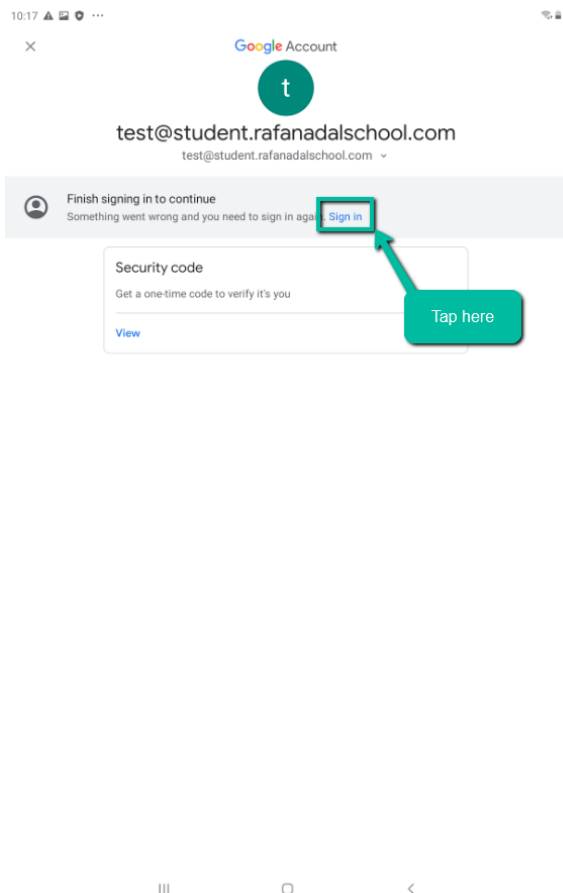

8. To check all is setup correctly, you can try to create a Google Drive folder,

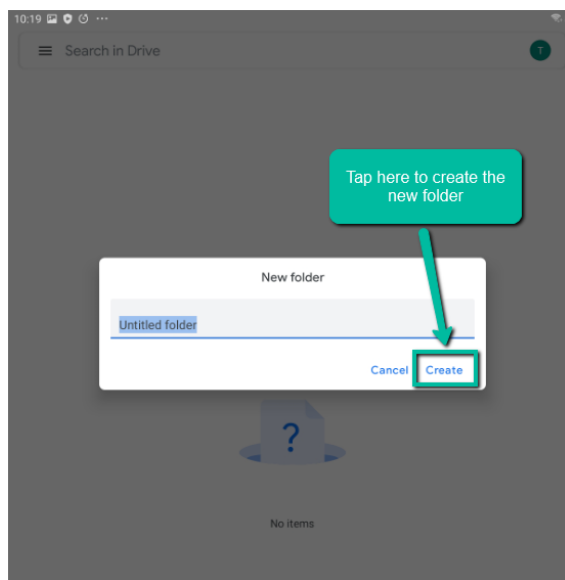
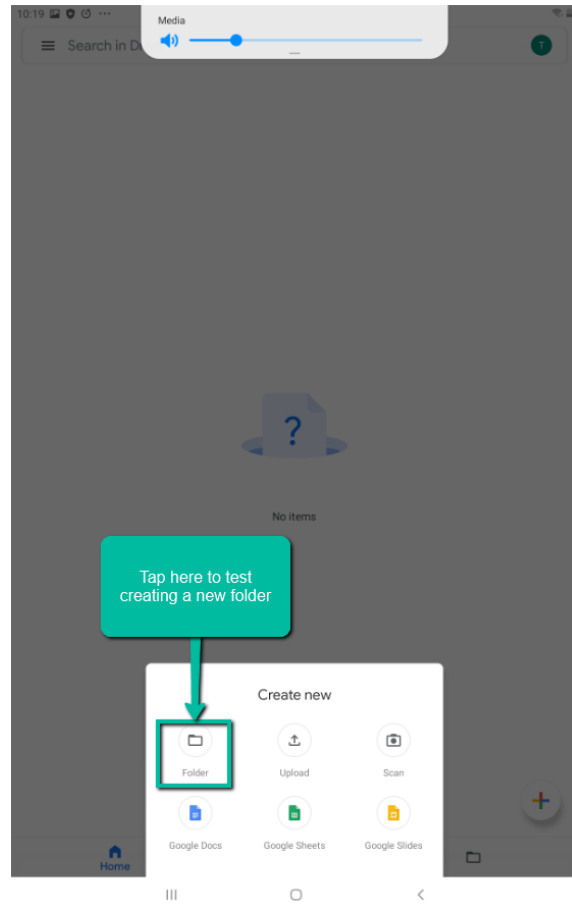

9. **Now your folder is created and your setup is complete!** You should be able to open any other Google app, without having to login again.

